

PURE VIEW | GLASS RAILING

SIMPLIFIED



Aluminum Rails



Iron Rails

GLASS MADE. FORTRESS CLEAR.

Traditionally when using a glass system it is complicated to order and install. Fortress has simplified the Glass Railing industry by developing a simple drop in solution that is easy. Choose your design by the choice of Full Glass Panel or Glass Balusters and enjoy the view with peace of mind that your system is not only beautiful but Fortress Strong.





FEATURES & BENEFITS

- Open your view - it's clearly a good idea!
- Quicker, easier installation with "Drop in" style glass panel and balusters
- Minimal rail profile for unobstructed view
- Works with Wood, Composite, Vinyl or Fortress Posts
- Premium powder coat offers long term, low maintenance, system
- Cost effective and elegant glass railing system eliminating custom cutting of glass panels
- Glass Balusters Tested in accordance with AC208, IRC & OBC/NBCC

SIMPLE ASSEMBLY EASY AS 1, 2, 3 **FORTRESS**

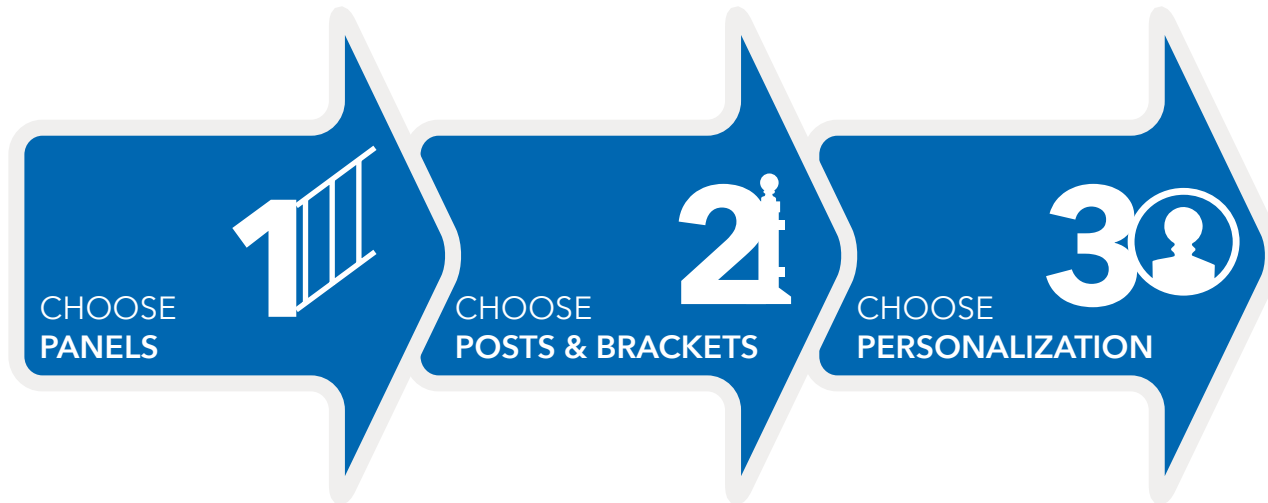

FORTRESS

PREMIUM FINISH

Fortress Pure View Glass Railing is available in four premium finishes engineered to withstand the elements.

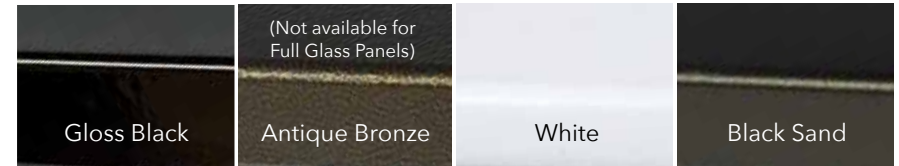

Protected with

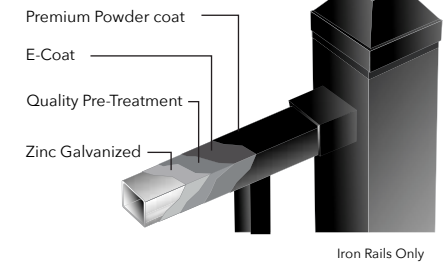
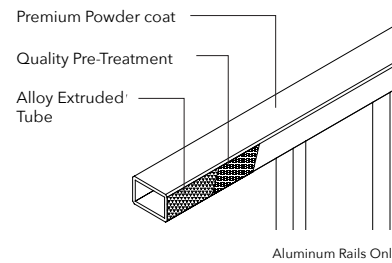

PURE VIEW | GLASS RAILING

SELECTION SIMPLIFIED

| PANELS

All panels can be used with several types of posts such as Metal, Wood, Vinyl or Composite.

LEVEL

FULL GLASS PANEL (ALUMINUM RAILS)

Glass Widths: 31.25" | 36.25" | 41.25" | 46.25" | 51.25" | 56.25" | 61.25"



GLASS BALUSTERS (ALUMINUM & IRON RAIL OPTIONS)

Choose from Iron or Aluminum for your pre-slotted rails.

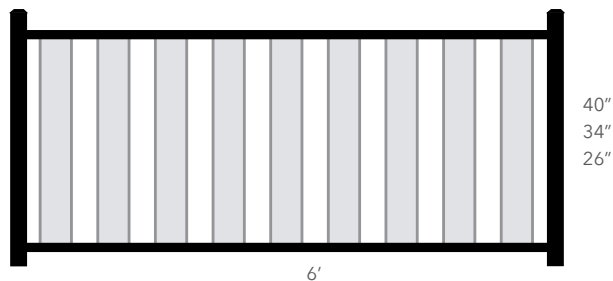

STAIR

GLASS BALUSTERS ADJUSTABLE (ALUMINUM & IRON RAIL OPTIONS)

Choose from Iron or Aluminum for your pre-slotted rails.

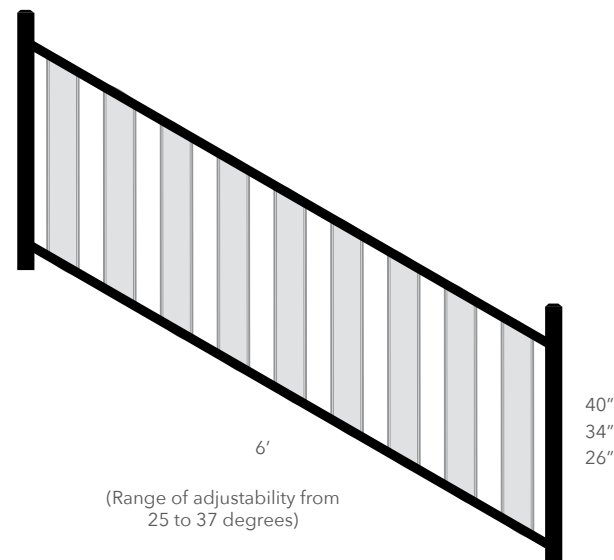

Iron Aluminum
(Panel Supports Required)

Reference the Fortress Railing Product Grid on page 67 for exact dimensions



2 | POSTS & BRACKETS

POSTS

All post base plates are pre-drilled enabling ease of wiring for lighting installations.

45.5"
(Goes with 40" rail panel)

39.5"
(Goes with any rail panel height of 34" and below)

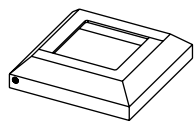

(Post Base Covers included in box)

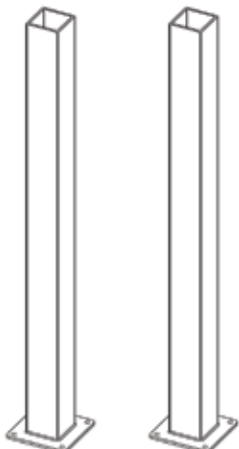

2"
(Iron)

3"
(Iron & Aluminum)

BRACKETS

IRON COLLAR BRACKET Traditional Fasteners



CB-05
(Level)



CBS-ADJ-05
(Angle)



CB-ADJ-05
(Stair)

UNIVERSAL BRACKET Hidden Fasteners (Patent Pending)



UB-05
(Level)



UB-ANG-05
(Add to Universal Bracket for Stair or Angle Applications)

ALUMINUM EVOLVE BRACKET Hidden Fasteners

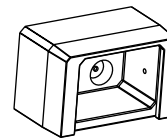

External
(Level)
(Patent Pending)

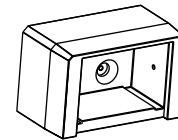

External Large
(only use with Accent Top Panels)

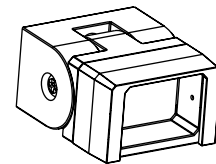

Stair

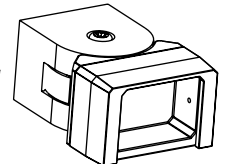

Angle

Low Profile Fasteners

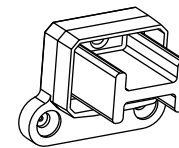

Internal
(Level)

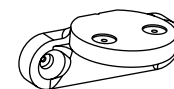

P2 Level
Must use when using Accent Top Rail or for use with Accent Top Panels
(Level or Angle)

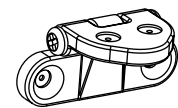

P2 Stair
(Stair)

POST ACCESSORIES

CAPS

(Without Lighting Capability)



CAPS

(With Lighting Capability)

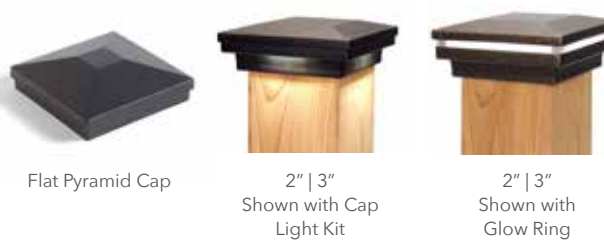

(For details on applications visit the FortressAccents on Page 45)

POST BASE COVER

(Use with Wood, Vinyl or Composite Posts)



GATES

GATE UPRIGHTS (MAKE A GATE)

(Use with Glass Balusters only)



ACCENT LIGHTING

LED LIGHT MOUNTS

(For details on applications visit the FortressAccents on Page 45)



HANDRAIL: SQUARE | ROUND



